



715 Locust St  
Evansville IN 47708  
(812) 435-5770  
(812) 435-5500 (fax#)  
[www.smgevansville.com](http://www.smgevansville.com)

The *Old National Events Plaza* is a clean air facility and smoking is prohibited.

## Management Team

---

### **General Manager**

Darren Stearns  
(812) 435-5770 x 204  
[Darren\\_stearns@smgevansville.com](mailto:Darren_stearns@smgevansville.com)

### **Box Office Manager**

Cindy Gehring  
(812) 435-5770 x210  
[cgehring@smgevansville.com](mailto:cgehring@smgevansville.com)

### **Events/Stage Manager**

Ashley Riester  
(812) 435-5770 x308  
[ariester@smgevansville.com](mailto:ariester@smgevansville.com)

### **Director of Operations**

Harry Cochran  
(812) 435-5770 x209  
[hcochran@smgevansville.com](mailto:hcochran@smgevansville.com)

### **Marketing & Merchandise Contact**

Kathy Embry  
(812) 435-5770 x212  
[kembry@smgevansville.com](mailto:kembry@smgevansville.com)

### **Director of Sales**

Megan Heronemus  
(812) 435-5770 x202  
[mheronemus@smgevansville.com](mailto:mheronemus@smgevansville.com)

### **Food & Beverage Manager**

Curtis Vickers  
(812) 435-5770 x 307  
[cvickers@smgevansville.com](mailto:cvickers@smgevansville.com)

## Disabled Access

---

- All public restrooms are wheelchair accessible. Specific dressing rooms also have disabled access. Please contact Production Manager regarding this.
- The Evansville Auditorium has Sennheiser infrared hearing assistance headsets.

## Travel Directions

---

**All routes are full truck and trailer height.**

**From East or West Interstate 64**

Take US 41 South turn West (right) onto Walnut Street. The Evansville Auditorium and Convention Centre is on the Corner of Walnut and Martin Luther King Jr. Blvd.

**From North or South US Highway 41**

Turn West on Walnut Street. The Evansville Auditorium and Convention Centre is on the Corner of Walnut and Martin Luther King Jr. Blvd.

**From East State Highway 66**

Take State Highway 66 West. Continue West at State Highway 62 (Lloyd Expressway). Exit off the Martin Luther King Jr. Blvd. Once at the stop sign turn left onto Martin Luther King Jr. Blvd. The Evansville Auditorium and Convention Centre is on the corner of Walnut and Martin Luther King Blvd. Jr.

**From West State Highway 62**

Take State Highway 62 (Lloyd Expressway) East. Exit the First Avenue Exit (the exit road is John Street). Continue on John Street and turn right onto Martin Luther King Blvd. Jr. The Evansville Auditorium and Convention Centre is on the corner of Walnut and Martin Luther King Blvd. Jr.

## Parking

---

**The following are the options for exhibitors and guests:**

- Civic Center Parking Lot – directly behind the Centre\*
- Off-Street Parking\*

**Other area Parking Garages at the corner of:**

- 3<sup>rd</sup> and Locust
- 5<sup>th</sup> and Locust
- 6<sup>th</sup> and Sycamore

These have limited spaces. Most are rented spaces.

**Truck and Trailer parking is located nearby.**

\*Limited parking Monday-Friday 8-5pm

# General Information and Vendor List

## Hospitals

Deaconess Clinic  
401 SE 6<sup>th</sup> Street  
Evansville, IN 47708  
(812) 426-8411

St. Mary's Hospital  
3700 Washington Ave  
Evansville, IN 47722  
(812) 485-4000

Deaconess Hospital  
600 Mary Street  
Evansville, IN 47711  
(812) 426-3000

## Ambulance Service

- SLR Ambulance (812) 425-8000
- American Medical Response (812) 428-2211

## Doctors

*\*(These doctors are a contact. They can also refer you to other doctors in the area.)*

- Chiropractor Dr. Alan Bee (812) 423-9146
- Dentist Patrick Tomley (812) 423-3426
- Doctor Carol Ann Goodman (812) 456-9736

## Fire Inspection

- Evansville Fire Dept. (812) 426-5609

## Police

- Executive Administrative Offices (812) 435-5317

## Catering

- SMG Catering *(Exclusive)* (812) 435-5770 x 301

## Florist

- Flowers and More (812) 424-8931
- Zeidler's Floral (812) 425-7272

## Forklift Rental (One available for rent in-house)

- Black Equipment (812) 477-6481
- Equipment Depot (812) 425-8164
- Prolift (812) 428-6022

## Furniture Rental

- Aaron's Rental (812) 476-2600
- Davis Rental (812) 423-4764

## Ice

- Home City Ice (812) 425-8191
- Airgas (Dry Ice & Co2) (812) 422-1069

## Laundry Service

- Clayton's (812) 476-1359
- Pearl Laundry & Service (812) 425-6121

## Lighting

- Concept Sound & Light (812) 477-9327

## Limo

- AutoHaus Limousine Service (812) 476-5700

## Massage Therapist

- Carol Gott- BS, CMT (812) 568-6323
- Cherree Perigo & Associates (812) 474-9704
- Bodyworks Massage Therapy (812) 476-6323
- The Muscle Relaxation Center (812) 473-4777

## Music Store

- H&H Music (812) 477-5339

## Pipe & Drape (Also available for rent in-house)

- T.R.U. Event Rentals (812) 423-6744
- Bauer's Tents (812) 867-1040

## Power (Portable)

- Evapar (812) 425-8264
- HDI Matthews (606) 431-9911

## Sound

- Concept Sound & Light (812) 868-1200
- Midwest Sound (812) 479-5575

## Taxi

- Ace Cab (812) 424-1111
- River City Yellow Cab (812) 429-0000

## Telephone Service

- AT&T (800) 660-3000

## Translators for the Hearing Impaired

- Resource Center for Deaf & Hard of Hearing (812) 425-2726

## Hotels

	Phone #	Distance
Tropicana	(800) 342-5386	1 Mile
Days Inn Airport	(812) 464-1077	4 Miles
Clarion Inn	(812) 424-6400	4.2 Miles
Drury Inn & Suites North	(812) 423-5818	4.3 Miles
Days Inn East	(812) 473-7944	4.5 Miles
Fairfield Inn West	(812) 429-0900	4.5 Miles
Holiday Inn West	(812) 421-9773	5 Miles
Jameson Inn	(812) 476-9626	5 Miles
Drury Inn & Suites East	(812) 425-5818	6 Miles
Fairfield Inn East	(812) 471-7000	6.2 Miles
Baymont Inn East	(812) 477-2677	6.3 Miles
Hampton Inn East	(812) 473-5000	6.3 Miles
Hilton Garden Inn East	(812) 476-4000	6.3 Miles
Holiday Inn Airport Hotel	(812) 867-7999	6.4 Miles
Comfort Inn East	(812) 476-3600	6.7 Miles

---

# Tour Production Management

---

## Production Office

- A Tour Production Office is available directly backstage.
- Phone lines can be made available in this office upon request. They are charged on a per day basis. All telephones require the use of a calling card or (800) number for long distance calls.
- Wireless high speed Internet is available throughout the building. It is a AT&T wireless hotspot that SMG has no control over. AT&T Wi-Fi is one of the options on your connections screen, and you pay online thru that site. It is 24hrs. of access.
- A direct Ethernet line is available in the Production office only, for \$175.00 per day

## Catering

- Exclusive Catering thru SMG Catering, full on-site kitchen.
- Please contact Catering Sales Manager, Kristin Masterson for more information (812) 435-5770 x 301

## Time Zone

- Evansville is located in the Central Time Zone and observes daylight savings.

## Labor

- All stage and truck labor is provided through IATSE local 102.
- For current stagehand rates, and to advance labor, contact house Production Manager.
- Business Agent: Greg Mills
  - (812) 467-0287 office

## Stage Manager Panel

A full PSM location is situated DSR. With FOH camera, paging, intercom and house light control.

## Front Of House

- Located 88' from the edge of stage. There is plenty of room for sound and light mixing boards. Dimensions are 22'4" wide x 9'8" deep.
- Full control of house lights, work lights, and running lights. Intercom to all locations in venue. Audio and lighting control patch.

## Policies

- Lobby opens 1hr prior and House opens 1/2hr prior to event, unless otherwise noted.
- Food & Beverage is permitted inside the facility during events, unless otherwise noted.
- Alcohol can only be acquired/purchased through SMG .
- All signage is prohibited without prior approval.
- Evansville Auditorium and Convention Centre is a clean air facility and smoking is prohibited. This includes dressing rooms and all back-stage areas.

## Support Areas

- Crossover back stage from USL and USR.
- Wardrobe Room (approx. 30'x 16' in size) is located off-stage right, with sink, 2 washers, and 2 dryers. Additional machines can be rented. Storage room off SL has hook-up for 1 additional washer and dryer if needed.
- Green Room located off-stage left, with video and program feed.
- Storage area available in staging area. NOTE: This is also loading area.

## Dressing Rooms

- 5 Star dressing rooms with ADA restrooms are available on the stage level, near stage.
- 2 Chorus dressing rooms with wheelchair accessible bathrooms and showers in basement level. The men's chorus room has 23 spaces and the women's has 26.
- 5 Star dressing rooms with bathroom and shower in basement level.
- Costume racks are located in each dressing room.
- Video monitors and program feeds in each dressing room.

## Telephones

- Production office phone lines are available upon request as a daily rental.
- Dressing room and other phone lines are available at the expense of the promoter. All line and activation charges will be required at settlement.
- All telephones require the use of a calling card or (800) number for long distance calls.

## Load-in / Load-out

---

- Enter Walnut St. East of Martin Luther King Jr.
- There are a total of four covered truck-height loading docks for the facility. Two of these are dedicated to the Auditorium (docks 3 and 4, marked above doors). There is a single auto-leveling dock plate at this location. The second dock must use a portable dock plate that is available on site.
- Loading Dock Door measures 8'x10'.
- Stage and loading area are on the same level. Stage is approximately 50' from dock.
- There is the potential to unload 4 trucks simultaneously, provided no other event is in the venue. This requires a long push from the farthest docks.
- Forklifts must be rented on a per-event basis. IATSE Stagehands serve as forklift operators.
- There is no shore power available

## Carpentry

---

### Obstructions

See diagram for loading area, stage obstructions and overhead clearances.

### Seating

See Appendix G for complete seating diagram.

Orchestra	1400
Grand Tier	800
<u>Balcony</u>	<u>371</u>
Total	2571

### Stage

- Proscenium stage with hydraulic orchestra pit.
- ¾" Resin-Impregnated load-absorbing stage floor.
- Stage Height: 3'-8" from auditorium floor.
- SL Wing Space: 19'-0" off stage x 43'-0" upstage
- SR Wing Space: 20'-0" off stage x 43'-0" upstage

### Important Measurements:

- Proscenium Width: 57'-11"
- Proscenium Height: 28'
- Wall To Wall Stage Width: 98'
- Center Line to Fly Floor Edge: 41'-5"
- Plaster Line to First US Obstruction: 43'
- DS Edge to First US Obstruction: 52'
- DS edge of Orchestra Pit to First US Obstruction with Pit at Stage Level: 59'-10"
- DS Edge to Plaster Line: 9'
- DS Edge to Plaster Line with Orchestra Pit at Stage Level: 16'-10"
- 2<sup>nd</sup> Catwalk to DSC: 62'-67'
- 3<sup>rd</sup> Catwalk to DSC: 90'-94'
- Box boom 1 to DSC: 79'-83'
- Box boom 2 to DSC: 121'-124'
- Follow spot Booth to DSC: 153'
- FOH to DSC: 88'
- Projection and Control Room to DSC: 120'
- Balcony Rail 1 to DSC: 93'-95'
- Balcony Rail 2 to DSC: 125'-127'
- Mix position is 22'4" wide x 9'8" deep.

## Soft goods

- The Centre has a full complement of standard masking and soft goods.
- Burgundy Main Traveler and Valence/Guillotine operated from SR.
- No scrims at this time.
- A full-stage, white cyclorama is hung upstage.
- Legs are 30' long x 18' wide.

## Rigging

- Double Purchase system from Tiffen Rigging. Re-roped w/ Multi Line II August 2002
- Total Weight Available: ~25,000#
- Grid Height: 61'-0"
- Bottom of loft: 60'-0"
- Maximum Fly Height: 59'-0"
- Battens-See Line set Schedule
  - 49—70'-0" double purchase on ~6" centers
  - 4—70'-0" motorized dedicated electric battens
  - 2 motorized dedicated orchestra shell ceiling panels
- Arbor Capacity: 2000# (1000# at pipe)
- Pin Rail: SL wing 10'-0" above stage floor, on fly floor.
- Batten Length: 70'-0"
- Electric Batten Length: 70'-0"
- Electric Batten Capacity: 2000#
- Chain motors can be rigged from grid using 4" schedule 80 pipe sections. Standard safe rigging practices are required.
- Chain motor rigging at the proscenium edge is limited to specific locations and load limits.
- See Appendix E for Lineset schedule

## Miscellaneous

- 150 Shelby Williams-brand orchestra chairs
- 25 music stands or stand lights at this time.

## Audio (all below mentioned equipment, except speakers, is located in sound booth)

---

- DDA CS3/ 40 channel Audio board
- Left and right stack has EAW MH660E long throw md/hi, 2 BV525 long throw bass, and MH690IE mid throw mid/hi.
- 93dB Max
- The center cluster has EAW AS690 mid/hi/low, and MH690IE hi/mid/short throw.
- There are MK2194 speakers positioned on the catwalks, and various other smaller speakers on the pit lip and under balconies.
- Crown Com-tech 410, 810, and 1610 Amps
- EV EQ-131 Equalizers
- EAW MX8750 processors
- Rane AD22B digital delays
- Rane PE17 parametric equalizers
- Compressors
- 360 Systems Instant Replay machine
- PA rooms are located DSL and DSR in which to situate amps and stacks.
- A dedicated FOH position has been installed in the Auditorium. House tie-in can be accomplished here, or backstage.
- (3) 12" conduits run from FOH to the orchestra pit. Road snakes must use these, as there are no center aisles in the auditorium.

# Electrics

---

## Power

- Stage Left
  - 800A 208V, 3-phase fused disconnect
- Stage Right
  - 800A 208V, 3-phase fused disconnect
- Note: At this time, dedicated sound power has not been installed. A dedicated, isolated sound ground is available at each 800A location.

## Followspots

- House follow spots are 2k Xenon Super Troupers.
- Normal house follow spot positions are located 153' from DSC above and behind the second balcony.
- A second, closer position is available at the first Box Boom position, to each side of the auditorium. These positions have limited shots upstage.

## Lighting Desk

- ETC Obsession II 750
- Full moving light ability.
- 3 DMX universe outputs

## Control

DMX, Cat 5 Net and RFU connections are located at the following locations. DMX is fully patchable as (4) independent, discrete universes, through two independent opto-isolators.

- Follow spot Booth
- Catwalk 3 right
- Catwalk 3 left
- Catwalk 2 right
- Catwalk 2 left
- Balcony Rail 2 right
- Balcony Rail 2 left
- Balcony Rail 1 right
- Balcony Rail 1 left
- Box Boom 2 right
- Box Boom 2 left
- Gridiron right
- Gridiron left
- DSR
- DSR
- USR
- USL
- Orchestra Pit

Typical house configuration places stage dimmers on Universe 1, and houselight dimmers and other architectural lighting on Universe 2. Patching allows these to be changed easily.

## Houselights

Houselight control is available in the control booth, Stage Managers Panel located DSR, and Front of House. All houselights are on dimmers, and multiple looks can be determined and recorded to presets at control locations. Vomitory and vestibule lighting control panels can be locked out from the control booth prior to the start of the show to prevent mishaps. Houselights are DMX, and may be connected to touring production lighting desks, provided manual control is still provided to the house for emergencies.



## **Over-stage Electrics**

3 motorized electric battens located over stage. Circuits are on 12" centers.

## **Dimmer Schedule**

- ETC Sensor dimmers.
- 2.4K per circuit.
- 441 dedicated stage dimmers.
- See Appendix F for complete schedule.

# Appendix A

## Facility, Stage and Loading Area Plan Views, Obstructions and Clearances

---

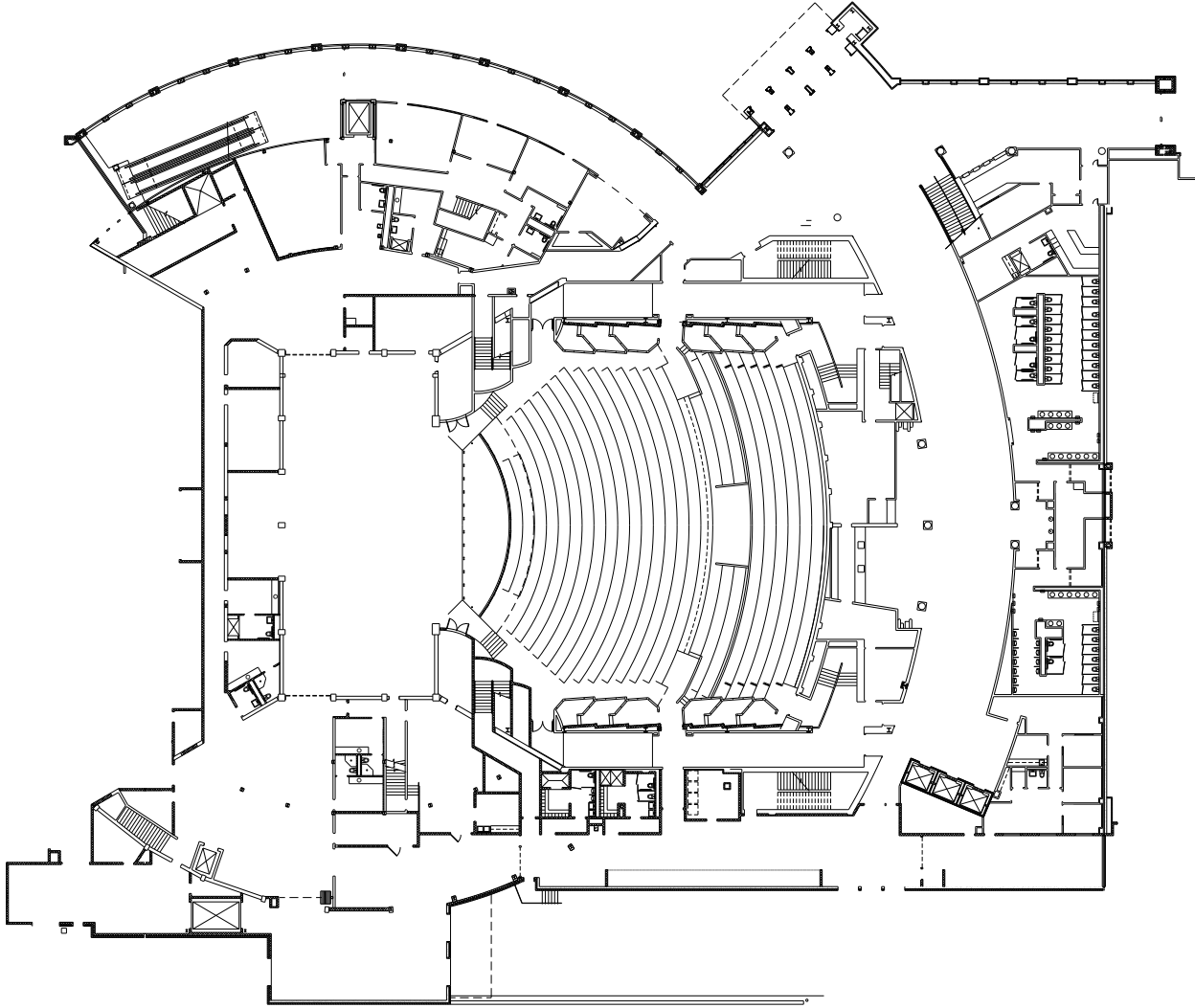

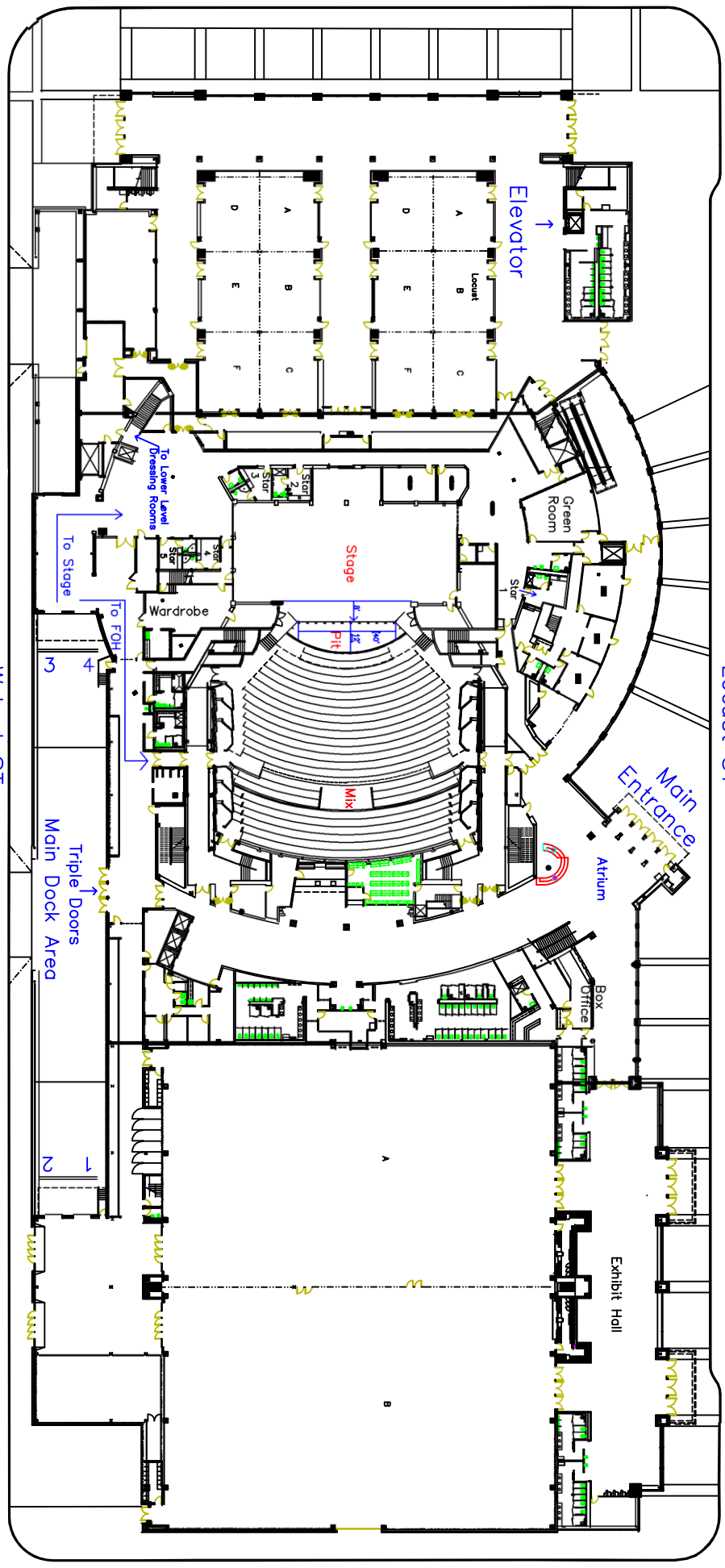

## Appendix E - Lineset Schedule

Lineset	Plaster Line	House Hang	Show Hang	Pipe Weight	Notes
	8"	Valence			Controls from SR
1	1'-5"	Main Drape			
2	2'-6"				
3	2'-11"				
	3'-7"	1 <sup>st</sup> Electric			
4	4'-4"				
5	5'				
6	5'-8"				
	6'-5"	1 <sup>st</sup> Orchestra Shell			
7	7'-5"				
8	7'-11"	1 <sup>st</sup> Border			
9	8'-6"	1 <sup>st</sup> Legs			
10	9'-1"				
11	9'-9"				
12	10'-4"				
13	11'-5"	1 <sup>st</sup> Traveler			
14	12'-8"				
15	13'	2 <sup>nd</sup> Border			
16	13'-8"	2 <sup>nd</sup> Legs			
17	14'-2"				
	15'-1"	2 <sup>nd</sup> Electric			
18	15'-10"				
19	16'-3"				
20	16'-9"				
21	17'-4"				
	18'-1"	2 <sup>nd</sup> Orchestra Shell			
22	18'-11"				
23	19'-4"				
24	19'-10"	3 <sup>rd</sup> Border			
25	20'-3"	3 <sup>rd</sup> Legs			
26	20'-7"				
27	21'-3"				
28	22'-7"	2 <sup>nd</sup> Traveler			
29	23'-4"				
	24'-5"	3 <sup>rd</sup> Electric			
30	25'-6"				
31	26'-3"	4 <sup>th</sup> Border			
32	27'-1"	4 <sup>th</sup> Legs			
33	28'-8"				
34	29'-3"				
35	29'-10"				
36	30'-8"				
37	31'-1"				
38	31'-9"	5 <sup>th</sup> legs			
39	33'-2"				
40	34'-2"				
41	35'				
42	35'-10"	5 <sup>th</sup> Border			
	36'-10"	4 <sup>th</sup> Electric			
43	37'-8"	3 <sup>rd</sup> Traveler			
44	38'-8"				
45	39'-5"				
46	40'-1"				
47	41'	4 <sup>th</sup> Traveler			Empty track
48	41'-8"	Cyc			
49	42'-5"				Very close to back wall
Quick Notes		Width of stage is 101' from wall to wall.	Plaster line to back wall is 44'.	Double purchase system.	Proscenium opening is 58'.

## Dimmer Schedule

1-4	Followspot Booth	
5-16	1 <sup>st</sup> Balcony Rail	
17-22	2 <sup>nd</sup> Balcony Box Seat House Left	
23-28	2 <sup>nd</sup> Balcony Box Seat House Right	
29-40	2 <sup>nd</sup> Balcony Rail	
41-82	2 <sup>nd</sup> Catwalk	
83-127	1 <sup>st</sup> Catwalk	
128-145	Proscenium Catwalk	
146-151	House Left Box Boom 1	
152-157	House Right Box Boom 1	
158-163	House Left Box Boom 2	
164-169	House Right Box Boom 2	
170-173	Orchestra Pit Stage Right	
174-177	Orchestra Pit Stage Left	
178-217	1 <sup>st</sup> Electric	
218-257	2 <sup>nd</sup> Electric	
258-297	3 <sup>rd</sup> Electric	
298-337	Cyc Electric	
	Drop Box – Dimmer #'s available	
	Drop Box	
	Drop Box	
	Drop Box	
	Drop Box	
	Drop Box	
410-417	Down-Stage Right Proscenium Wall	
418-425	Down-Stage Left Proscenium Wall	
426-433	Up-Stage Right Proscenium Wall	
434-441	Up-Stage Left Proscenium Wall	
445-462	1 <sup>st</sup> Orchestra Shell Electrics	Dedicated
463-480	2 <sup>nd</sup> Orchestra Shell Electrics	Dedicated
494-505	Down-Stage Platform Zipstrips	Dedicated
506-513	Up-Stage Platform Zipstrips	Dedicated
514-517	Proscenium Catwalk	

A full-length dimmer schedule is available for production Master Electricians to aid in patch.

# Available Equipment

---

## Lighting

- (18) ETC Source 419
- (14) ETC Source 410
- (18) ETC Source 426
- (18) ETC Source 450
- (54) Source 4 PAR w/4 lens set
- (5) Source 4 Zoom 15 – 30 degree
- (20) Lee Colortran 6" fresnels
- (26) Lee Colortran 30° ellipsoidals
- (6) Lee Colortran 15° ellipsoidals
- (4) Super Trooper 2K

## Audio

- (10) SM58 microphones
- (6) Crown PCC microphones
- (6) EV RE11 microphones
- Denon CD Player
- Cassette Deck
- 360 Systems Instant Replay
- Atlas microphone stands
- (2) Mackie 1402 mic/line mixers

## Staging and Risers

- (12) 16" – 24" Stage Right riser frames
- (12) 24" – 36" Stage Right riser frames
- (22) 36" – 52" Stage Right riser frames, bridgeable
- (41) Stage Right riser decks

## Labor and Equipment Rates

<b>Labor Rates</b>		
<b>House Staff</b>	<b>Rate</b>	<b>Minimum Hours</b>
Supervisors	\$23.00/Hr	5
Ushers	\$375.00	Per Performance
Ticket Seller/Taker	\$14/Hr	4
Receptionist	\$14/Hr	6
House Light Operator	\$17.00/Hr	4
	\$350.00	First 2 Hours
First Aid/ Paramedic/ Ambulance	\$125.00	Each Additional Hour
Maids/Porters	\$17.50/Hr	5
Teamster Overtime	\$32.50/Hr	No Minimum
<b>Security</b>	<b>Rate</b>	<b>Minimum Hours</b>
ESG (T-Shirt) Security	\$17.00/Hr	4
Uniform Security	\$32.50/Hr	5
Firefighter	\$35.00/Hr	4
<b>Equipment Rates</b>		
<b>Item</b>	<b>Rate</b>	<b>Per</b>
Spotlights	\$130.00	Per Day
Pallet Jack	\$20.00	Per Day
Forklift	\$175.00	Per Day
Genie Lift	\$175.00	Per Day
Scissor Lift- 20'	\$200.00	Per Day
Scissor Lift- 30'	\$250.00	Per Day
Boom Lift- 42'	\$350.00	Per Day
Telephone Line	\$125.00	Per Line
High Speed Internet Line	\$175.00	Per Line
Lectern (Standing, Table Top, ADA)	\$10.00	Per Day
Microphone (Hand Held w/ Cord)	\$15.00	Per Day
Microphone (Wireless Hand Held-VHF)	\$50.00	Per Day
Microphone (Wireless Lavalier-VHF)	\$50.00	Per Day
Risers- 16" or 24" (4'x8' Section)	\$0.55	Per Sq. Foot
Risers- 36" (4'x8' Section)	\$0.75	Per Sq. Foot
Orchestra Shell	\$150.00	Per Event
Dance Floor (3'x3' Sections)	\$0.25	Per Sq. Foot
Easel	\$7.00	Per Day
Dry Erase Board	\$10.00	Per Day
Flip Chart (Standard Paper)	\$15.00	Per Day
Flip Chart (Sticky Paper)	\$25.00	Per Day
Towels	\$4.00	Each
Gaffe Tape	\$15.00	Per Roll
<b>Miscellaneous</b>		
House Sound Hook Up Fee	\$200.00	One Time
Balloon Retrieval	\$250.00	Per Balloon
Runner	\$225.00	Per Day

**Note:**

All equipment is available on a first come first serve basis. If additional rental items are needed they will be billed at vendor rental rates.