



715 Locust St
Evansville IN 47708
(812) 435-5770
(812) 435-5500 (fax#)
www.smgevansville.com

The *Old National Events Plaza* is a clean air facility and smoking is prohibited.

Management Team

General Manager

Alexis Berggren
(812) 435-5770 x 204
Aberggren@smgevansville.com

Box Office Manager

Cindy Gehring
(812) 435-5770 x210
cgehring@smgevansville.com

Event/Stage Manager

Ashley Riester
(812) 435-5770 x308
ariester@smgevansville.com

Director of Operations

Harry Cochran
(812) 435-5770 x209
hcochran@smgevansville.com

Marketing & Merchandise Contact

Kathy Embry
(812) 435-5770 x212
kembry@smgevansville.com

Director of Sales

Megan Heronemus
(812) 435-5770 x202
mheronemus@smgevansville.com

Food & Beverage Manager

Curtis Vickers
(812) 435-5770 x 307
cvickers@smgevansville.com

Disabled Access

- All public restrooms are wheelchair accessible. Specific dressing rooms also have disabled access. Please contact Production Manager regarding this.
- Old National Events Plaza has Sennheiser infrared hearing assistance headsets.

Travel Directions

All routes are full truck and trailer height.

From East or West Interstate 64

Take US 41 South turn West (right) onto Walnut Street. Old National Events Plaza is on the Corner of Walnut and Martin Luther King Jr. Blvd.

From North or South US Highway 41

Turn West on Walnut Street. Old National Events Plaza is on the Corner of Walnut and Martin Luther King Jr. Blvd.

From East State Highway 66

Take State Highway 66 West. Continue West at State Highway 62 (Lloyd Expressway). Exit off the Martin Luther King Jr. Blvd. Once at the stop sign turn left onto Martin Luther King Jr. Blvd. Old National Events Plaza is on the corner of Walnut and Martin Luther King Blvd. Jr.

From West State Highway 62

Take State Highway 62 (Lloyd Expressway) East. Exit the First Avenue Exit (the exit road is John Street). Continue on John Street and turn right onto Martin Luther King Blvd. Jr. Old National Events Plaza is on the corner of Walnut and Martin Luther King Blvd. Jr.

Parking

The following are the options for exhibitors and guests:

- Civic Center Parking Lot – directly behind the Old National Events Plaza*
- Off-Street Parking*

Other area Parking Garages at the corner of:

- 3rd and Locust
- 5th and Locust
- 6th and Sycamore

These have limited spaces. Most are rented spaces.

Truck and Trailer parking is located nearby.

*Limited parking Monday-Friday 8-5pm

General Information and Vendor List

Hospitals

Deaconess Clinic
401 SE 6th Street
Evansville, IN 47708
(812) 426-8411

St. Vincent Hospital
3700 Washington Ave
Evansville, IN 47722
(812) 485-4000

Deaconess Hospital
600 Mary Street
Evansville, IN 47711
(812) 426-3000

Ambulance Service

- SLR Ambulance (812) 425-8000
- American Medical Response (812) 428-2211

Doctors

**(These doctors are a contact. They can also refer you to other doctors in the area.)*

- Chiropractor Dr. Alan Bee (812) 423-9146
- Dentist Patrick Tomley (812) 423-3426
- Doctor Carol Ann Goodman (812) 456-9736

Fire Inspection

- Evansville Fire Dept. (812) 426-5609

Police

- Executive Administrative Offices (812) 435-5317

Catering

- SMG Catering *(Exclusive)* (812) 435-5770 x 301

Florist

- Flowers and More (812) 424-8931
- Zeidler's Floral (812) 425-7272

Forklift Rental (One available for rent in-house)

- Black Equipment (812) 477-6481
- Equipment Depot (812) 425-8164
- Prolift (812) 428-6022

Furniture Rental

- Rent-A-Center (812) 421-0444

Ice

- Home City Ice (812) 425-8191
- Airgas (Dry Ice & Co2) (812) 422-1069

Laundry Service

- Clayton's (812) 476-1359
- Pearl Laundry & Service (812) 425-6121

Lighting

- Concept Sound & Light (812) 477-9327

Limo

- AutoHaus Limousine Service (812) 476-5700

Massage Therapist

- Carol Gott- BS, CMT (812) 568-6323
- Cherree Perigo & Associates (812) 474-9704
- Bodyworks Massage Therapy (812) 476-6323
- The Muscle Relaxation Center (812) 473-4777

Music Store

- H&H Music (812) 477-5339

Pipe & Drape (Also available for rent in-house)

- T.R.U. Event Rentals (812) 423-6744
- Bauer's Tents (812) 867-1040

Power (Portable)

- Evapar (812) 425-8264
- HDI Matthews (606) 431-9911

Sound

- Concept Sound & Light (812) 868-1200
- Midwest Sound (812) 479-5575

Taxi

- Ace Cab (812) 424-1111
- River City Yellow Cab (812) 429-0000

Telephone Service

- AT&T (800) 660-3000

Translators for the Hearing Impaired

- Resource Center for Deaf & Hard of Hearing (812) 425-2726

Hotels

| | Phone # | Distance |
|---------------------------|----------------|-----------|
| Double Tree by Hilton | (812) 423-5002 | <1 Mile |
| Tropicana | (800) 342-5386 | 1 Mile |
| Days Inn Airport | (812) 464-1077 | 4 Miles |
| Clarion Inn | (812) 424-6400 | 4.2 Miles |
| Drury Inn & Suites North | (812) 423-5818 | 4.3 Miles |
| Days Inn East | (812) 473-7944 | 4.5 Miles |
| Fairfield Inn West | (812) 429-0900 | 4.5 Miles |
| Holiday Inn West | (812) 421-9773 | 5 Miles |
| Jameson Inn | (812) 476-9626 | 5 Miles |
| Drury Inn & Suites East | (812) 425-5818 | 6 Miles |
| Fairfield Inn East | (812) 471-7000 | 6.2 Miles |
| Baymont Inn East | (812) 477-2677 | 6.3 Miles |
| Hampton Inn East | (812) 473-5000 | 6.3 Miles |
| Hilton Garden Inn East | (812) 476-4000 | 6.3 Miles |
| Holiday Inn Airport Hotel | (812) 867-7999 | 6.4 Miles |
| Comfort Inn East | (812) 476-3600 | 6.7 Miles |

Tour Production Management

Production Office

- A Tour Production Office is available directly backstage.
- Phone lines can be made available in this office upon request. They are charged on a per day basis. All telephones require the use of a calling card or (800) number for long distance calls.
- Wireless high speed Internet is available throughout the building. It is a AT&T wireless hotspot that SMG has no control over. AT&T Wi-Fi is one of the options on your connections screen, and you pay online thru that site. It is 24hrs. of access.
- A direct Ethernet line is available in the Production office only, for \$175.00 per day

Catering

- Exclusive Catering thru SMG Catering, full on-site kitchen.
- Please contact Catering Sales Manager, Natasha Douglas for more information (812) 435-5770 x 301

Time Zone

- Evansville is located in the Central Time Zone and observes daylight savings.

Labor

- All stage and truck labor is provided through IATSE local 102.
- For current stagehand rates, and to advance labor, contact house Production Manager.
- Business Agent: Greg Mills
 - (812) 467-0287 office

Stage Manager Panel

A full PSM location is situated DSR. With FOH camera, paging, intercom and house light control.

Front Of House

- Located 88' from the edge of stage. There is plenty of room for sound and light mixing boards. Dimensions are 22'4" wide x 9'8" deep.
- Full control of house lights, work lights, and running lights. Intercom to all locations in venue. Audio and lighting control patch.

Policies

- Lobby opens 1hr prior and House opens 1/2hr prior to event, unless otherwise noted.
- Food & Beverage is permitted inside the facility during events, unless otherwise noted.
- Alcohol can only be acquired/purchased through SMG .
- All signage is prohibited without prior approval.
- Old National Events Plaza is a clean air facility and smoking is prohibited. This includes dressing rooms and all back-stage areas.

Support Areas

- Crossover back stage from USL and USR.
- Wardrobe Room (approx. 30'x 16' in size) is located off-stage right, with sink, 2 washers, and 2 dryers. Additional machines can be rented. Storage room off SL has hook-up for 1 additional washer and dryer if needed.
- Green Room located off-stage left, with video and program feed.
- Storage area available in staging area. NOTE: This is also loading area.

Dressing Rooms

- 5 Star dressing rooms with ADA restrooms are available on the stage level, near stage.
- 2 Chorus dressing rooms with wheelchair accessible bathrooms and showers in basement level. The men's chorus room has 23 spaces and the women's has 26.
- 5 Star dressing rooms with bathroom and shower in basement level.
- Costume racks are located in each dressing room.
- Video monitors and program feeds in each dressing room.

Telephones

- Production office phone lines are available upon request as a daily rental.
- Dressing room and other phone lines are available at the expense of the promoter. All line and activation charges will be required at settlement.
- All telephones require the use of a calling card or (800) number for long distance calls.

Load-in / Load-out

- Enter Walnut St. East of Martin Luther King Jr.
- There are a total of four covered truck-height loading docks for the facility. Two of these are dedicated to the Auditorium (docks 3 and 4, marked above doors). There is a single auto-leveling dock plate at this location. The second dock must use a portable dock plate that is available on site.
- Loading Dock Door measures 8'x10'.
- Stage and loading area are on the same level. Stage is approximately 50' from dock.
- There is the potential to unload 4 trucks simultaneously, provided no other event is in the venue. This requires a long push from the farthest docks.
- Forklifts must be rented on a per-event basis. IATSE Stagehands serve as forklift operators.
- There is no shore power available

Carpentry

Obstructions

See diagram for loading area, stage obstructions and overhead clearances.

Seating

See Appendix G for complete seating diagram.

| | |
|----------------|------------|
| Orchestra | 1400 |
| Grand Tier | 800 |
| <u>Balcony</u> | <u>371</u> |
| Total | 2571 |

Stage

- Proscenium stage with hydraulic orchestra pit.
- ¾" Resin-Impregnated load-absorbing stage floor.
- Stage Height: 3'-8" from auditorium floor.
- SL Wing Space: 19'-0" off stage x 43'-0" upstage
- SR Wing Space: 20'-0" off stage x 43'-0" upstage

Important Measurements:

- Proscenium Width: 57'-11"
- Proscenium Height: 28'
- Wall To Wall Stage Width: 98'
- Center Line to Fly Floor Edge: 41'-5"
- Plaster Line to First US Obstruction: 43'
- DS Edge to First US Obstruction: 52'
- DS edge of Orchestra Pit to First US Obstruction with Pit at Stage Level: 59'-10"
- DS Edge to Plaster Line: 9'
- DS Edge to Plaster Line with Orchestra Pit at Stage Level: 16'-10"
- 2nd Catwalk to DSC: 62'-67'
- 3rd Catwalk to DSC: 90'-94'
- Box boom 1 to DSC: 79'-83'
- Box boom 2 to DSC: 121'-124'
- Follow spot Booth to DSC: 153'
- FOH to DSC: 88'
- Projection and Control Room to DSC: 120'
- Balcony Rail 1 to DSC: 93'-95'
- Balcony Rail 2 to DSC: 125'-127'
- Mix position is 22'4" wide x 9'8" deep.

Soft goods

- Old National Events Plaza has a full complement of standard masking and soft goods.
- Burgundy Main Traveler and Valence/Guillotine operated from SR.
- No scrims at this time.
- A full-stage, white cyclorama is hung upstage.
- Legs are 30' long x 18' wide.

Rigging

- Double Purchase system from Tiffen Rigging. Re-roped w/ Multi Line II August 2002
- Total Weight Available: ~25,000#
- Grid Height: 61'-0"
- Bottom of loft: 60'-0"
- Maximum Fly Height: 59'-0"
- Battens-See Line set Schedule
 - 49—70'-0" double purchase on ~6" centers
 - 4—70'-0" motorized dedicated electric battens
 - 2 motorized dedicated orchestra shell ceiling panels
- Arbor Capacity: 2000# (1000# at pipe)
- Pin Rail: SL wing 10'-0" above stage floor, on fly floor.
- Batten Length: 70'-0"
- Electric Batten Length: 70'-0"
- Electric Batten Capacity: 2000#
- Chain motors can be rigged from grid using 4" schedule 80 pipe sections. Standard safe rigging practices are required.
- Chain motor rigging at the proscenium edge is limited to specific locations and load limits.
- See Appendix E for Lineset schedule

Miscellaneous

- 150 Shelby Williams-brand orchestra chairs
- 25 music stands or stand lights at this time.

Audio (all below mentioned equipment, except speakers, is located in sound booth)

- DDA CS3/ 40 channel Audio board
- Left and right stack has EAW MH660E long throw md/hi, 2 BV525 long throw bass, and MH690IE mid throw mid/hi.
- 93dB Max
- The center cluster has EAW AS690 mid/hi/low, and MH690IE hi/mid/short throw.
- There are MK2194 speakers positioned on the catwalks, and various other smaller speakers on the pit lip and under balconies.
- Crown Com-tech 410, 810, and 1610 Amps
- EV EQ-131 Equalizers
- EAW MX8750 processors
- Rane AD22B digital delays
- Rane PE17 parametric equalizers
- Compressors
- 360 Systems Instant Replay machine
- PA rooms are located DSL and DSR in which to situate amps and stacks.
- A dedicated FOH position has been installed in the Auditorium. House tie-in can be accomplished here, or backstage.
- (3) 12" conduits run from FOH to the orchestra pit. Road snakes must use these, as there are no center aisles in the auditorium.

Electrics

Power

- Stage Left
 - 800A 208V, 3-phase fused disconnect
- Stage Right
 - 800A 208V, 3-phase fused disconnect
- Note: At this time, dedicated sound power has not been installed. A dedicated, isolated sound ground is available at each 800A location.

Followspots

- House follow spots are 2k Xenon Super Troupers.
- Normal house follow spot positions are located 153' from DSC above and behind the second balcony.
- A second, closer position is available at the first Box Boom position, to each side of the auditorium. These positions have limited shots upstage.

Lighting Desk

- ETC Obsession II 750
- Full moving light ability.
- 3 DMX universe outputs

Control

DMX, Cat 5 Net and RFU connections are located at the following locations. DMX is fully patchable as (4) independent, discrete universes, through two independent opto-isolators.

- Follow spot Booth
- Catwalk 3 right
- Catwalk 3 left
- Catwalk 2 right
- Catwalk 2 left
- Balcony Rail 2 right
- Balcony Rail 2 left
- Balcony Rail 1 right
- Balcony Rail 1 left
- Box Boom 2 right
- Box Boom 2 left
- Gridiron right
- Gridiron left
- DSR
- DSR
- USR
- USL
- Orchestra Pit

Typical house configuration places stage dimmers on Universe 1, and houselight dimmers and other architectural lighting on Universe 2. Patching allows these to be changed easily.

Houselights

Houselight control is available in the control booth, Stage Managers Panel located DSR, and Front of House. All houselights are on dimmers, and multiple looks can be determined and recorded to presets at control locations. Vomitory and vestibule lighting control panels can be locked out from the control booth prior to the start of the show to prevent mishaps. Houselights are DMX, and may be connected to touring production lighting desks, provided manual control is still provided to the house for emergencies.

Over-stage Electrics

3 motorized electric battens located over stage. Circuits are on 12" centers.

Dimmer Schedule

- ETC Sensor dimmers.
- 2.4K per circuit.
- 441 dedicated stage dimmers.
- See Page 13 for complete schedule.

Appendix A

Facility, Stage and Loading Area Plan Views, Obstructions and Clearances

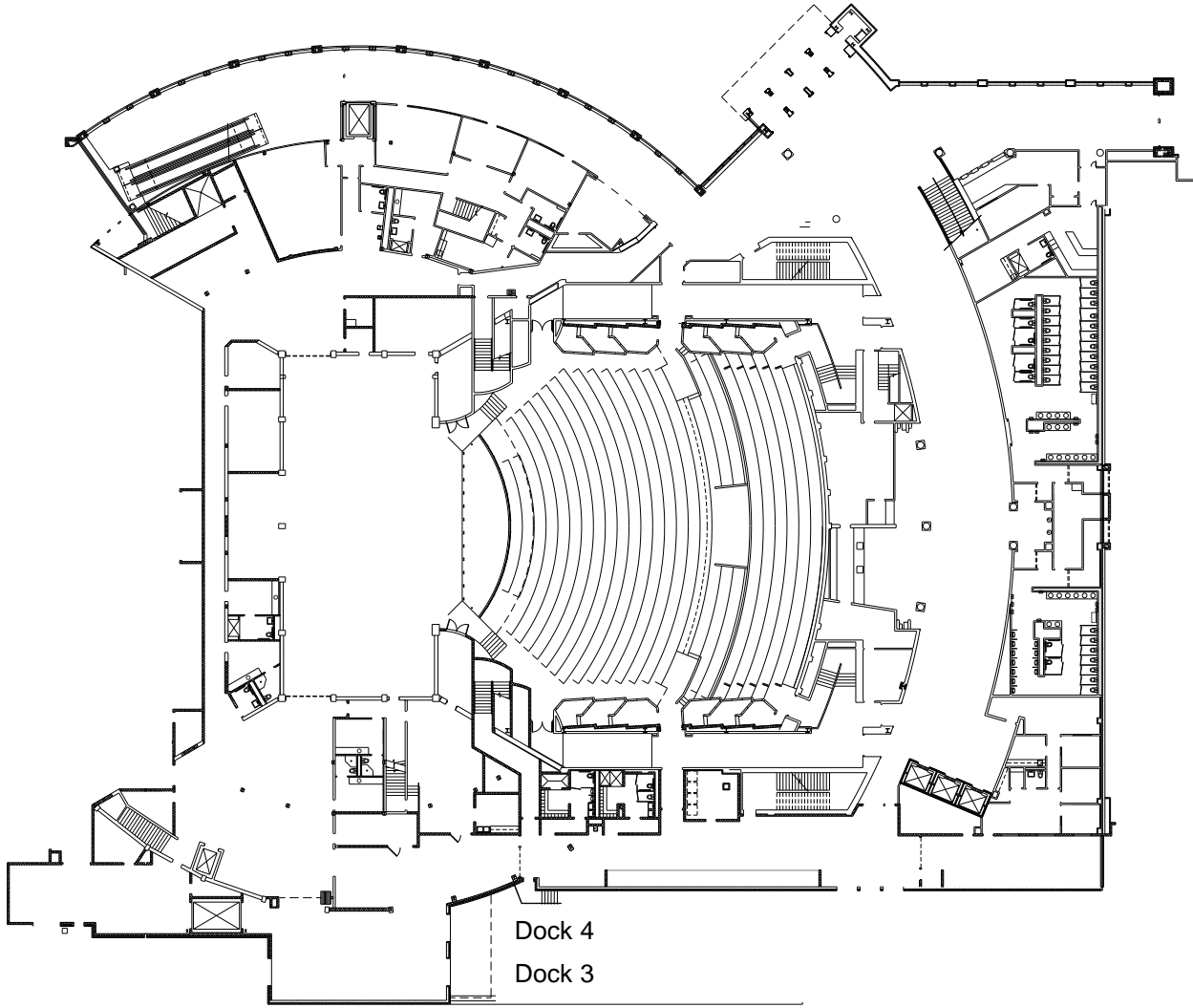

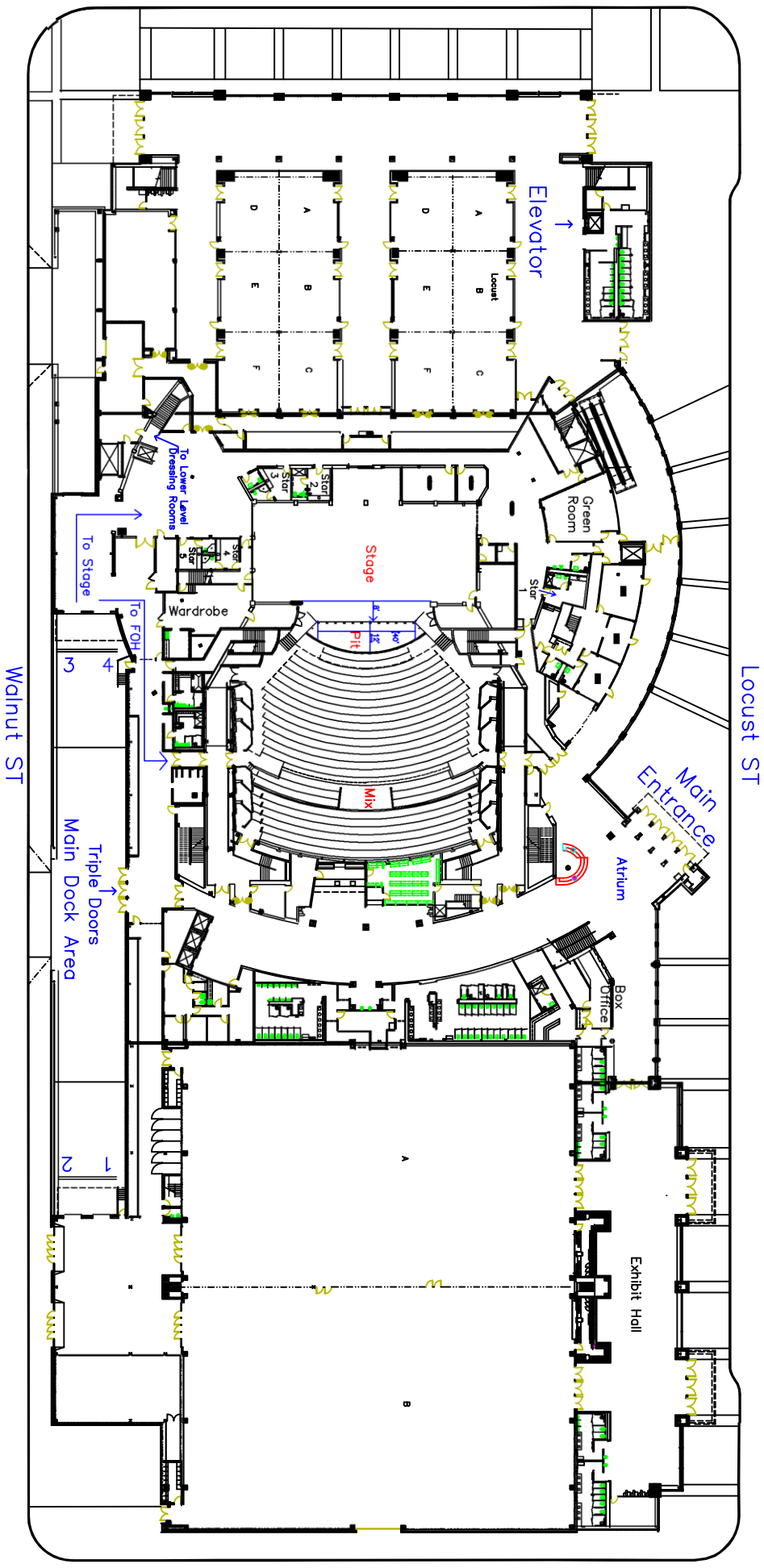

Appendix E - Lineset Schedule

| Lineset | Plaster Line | House Hang | Show Hang | Pipe Weight | Notes |
|-------------|--------------|---|-----------------------------------|-------------------------|----------------------------|
| | 8" | Valence | | | Controls from SR |
| 1 | 1'-5" | Main Drape | | | |
| 2 | 2'-6" | | | | |
| 3 | 2'-11" | | | | |
| | 3'-7" | 1 st Electric | | | |
| 4 | 4'-4" | | | | |
| 5 | 5' | | | | |
| 6 | 5'-8" | | | | |
| | 6'-5" | 1 st Orchestra Shell | | | |
| 7 | 7'-5" | | | | |
| 8 | 7'-11" | 1 st Border | | | |
| 9 | 8'-6" | 1 st Legs | | | |
| 10 | 9'-1" | | | | |
| 11 | 9'-9" | | | | |
| 12 | 10'-4" | | | | |
| 13 | 11'-5" | 1 st Traveler | | | |
| 14 | 12'-8" | | | | |
| 15 | 13' | 2 nd Border | | | |
| 16 | 13'-8" | 2 nd Legs | | | |
| 17 | 14'-2" | | | | |
| | 15'-1" | 2 nd Electric | | | |
| 18 | 15'-10" | | | | |
| 19 | 16'-3" | | | | |
| 20 | 16'-9" | | | | |
| 21 | 17'-4" | | | | |
| | 18'-1" | 2 nd Orchestra Shell | | | |
| 22 | 18'-11" | | | | |
| 23 | 19'-4" | | | | |
| 24 | 19'-10" | 3 rd Border | | | |
| 25 | 20'-3" | 3 rd Legs | | | |
| 26 | 20'-7" | | | | |
| 27 | 21'-3" | | | | |
| 28 | 22'-7" | 2 nd Traveler | | | |
| 29 | 23'-4" | | | | |
| | 24'-5" | 3 rd Electric | | | |
| 30 | 25'-6" | | | | |
| 31 | 26'-3" | 4 th Border | | | |
| 32 | 27'-1" | 4 th Legs | | | |
| 33 | 28'-8" | | | | |
| 34 | 29'-3" | | | | |
| 35 | 29'-10" | | | | |
| 36 | 30'-8" | | | | |
| 37 | 31'-1" | | | | |
| 38 | 31'-9" | 5 th legs | | | |
| 39 | 33'-2" | | | | |
| 40 | 34'-2" | | | | |
| 41 | 35' | | | | |
| 42 | 35'-10" | 5 th Border | | | |
| | 36'-10" | 4 th Electric | | | |
| 43 | 37'-8" | 3 rd Traveler | | | |
| 44 | 38'-8" | | | | |
| 45 | 39'-5" | | | | |
| 46 | 40'-1" | | | | |
| 47 | 41' | 4 th Traveler | | | Empty track |
| 48 | 41'-8" | Cyc | | | |
| 49 | 42'-5" | | | | Very close to back wall |
| Quick Notes | | Width of stage is 101' from wall to wall. | Plaster line to back wall is 44'. | Double purchase system. | Proscenium opening is 58'. |

Dimmer Schedule

| | | |
|---------|--|-----------|
| 1-4 | Followspot Booth | |
| 5-16 | 1 st Balcony Rail | |
| 17-22 | 2 nd Balcony Box Seat House Left | |
| 23-28 | 2 nd Balcony Box Seat House Right | |
| 29-40 | 2 nd Balcony Rail | |
| 41-82 | 2 nd Catwalk | |
| 83-127 | 1 st Catwalk | |
| 128-145 | Proscenium Catwalk | |
| 146-151 | House Left Box Boom 1 | |
| 152-157 | House Right Box Boom 1 | |
| 158-163 | House Left Box Boom 2 | |
| 164-169 | House Right Box Boom 2 | |
| 170-173 | Orchestra Pit Stage Right | |
| 174-177 | Orchestra Pit Stage Left | |
| 178-217 | 1 st Electric | |
| 218-257 | 2 nd Electric | |
| 258-297 | 3 rd Electric | |
| 298-337 | Cyc Electric | |
| | Drop Box – Dimmer #'s available | |
| | Drop Box | |
| | Drop Box | |
| | Drop Box | |
| | Drop Box | |
| | Drop Box | |
| 410-417 | Down-Stage Right Proscenium Wall | |
| 418-425 | Down-Stage Left Proscenium Wall | |
| 426-433 | Up-Stage Right Proscenium Wall | |
| 434-441 | Up-Stage Left Proscenium Wall | |
| 445-462 | 1 st Orchestra Shell Electrics | Dedicated |
| 463-480 | 2 nd Orchestra Shell Electrics | Dedicated |
| 494-505 | Down-Stage Platform Zipstrips | Dedicated |
| 506-513 | Up-Stage Platform Zipstrips | Dedicated |
| 514-517 | Proscenium Catwalk | |

A full-length dimmer schedule is available for production Master Electricians to aid in patch.

Available Equipment

Lighting

- (18) ETC Source 4 19°
- (14) ETC Source 4 10°
- (18) ETC Source 4 26°
- (18) ETC Source 4 50°
- (12) ETC Source 4 5°
- (54) Source 4 PAR w/4 lens set
- (5) Source 4 Zoom 15 – 30 degree
- (20) Lee Colortran 6" fresnels
- (26) Lee Colortran 30° ellipsoidals
- (6) Lee Colortran 15° ellipsoidals
- (4) Super Trooper 2K

Audio

- (10) SM58 microphones
- (6) Crown PCC microphones
- (6) EV RE11 microphones
- Denon CD Player
- Cassette Deck
- 360 Systems Instant Replay
- Atlas microphone stands
- (2) Mackie 1402 mic/line mixers

Staging and Risers

- (12) 16" – 24" Stage Right riser frames
- (12) 24" – 36" Stage Right riser frames
- (22) 36" – 52" Stage Right riser frames, bridgeable
- (41) Stage Right riser decks

Labor and Equipment Rates

| Labor Rates | | |
|-------------------------------------|-------------|----------------------|
| House Staff | Rate | Minimum Hours |
| Supervisors | \$23.00/Hr | 5 |
| Ushers | \$375.00 | Per Performance |
| Ticket Seller/Taker | \$14/Hr | 4 |
| Receptionist | \$14/Hr | 6 |
| House Light Operator | \$17.50/Hr | 4 |
| First Aid/ Paramedic/ Ambulance | \$350.00 | First 2 Hours |
| | \$125.00 | Each Additional Hour |
| Maids/Porters | \$17.50/Hr | 5 |
| Teamster Overtime | \$32.50/Hr | No Minimum |
| Security | Rate | Minimum Hours |
| (T-Shirt) Security | \$17.00/Hr | 4 |
| Uniform Security | \$32.50/Hr | 5 |
| Firefighter | \$35.00/Hr | 4 |
| Equipment Rates | | |
| Item | Rate | Per |
| Spotlights | \$130.00 | Per Day |
| Pallet Jack | \$20.00 | Per Day |
| Forklift | \$175.00 | Per Day |
| Genie Lift | \$175.00 | Per Day |
| Scissor Lift- 20' | \$200.00 | Per Day |
| Scissor Lift- 30' | \$250.00 | Per Day |
| Boom Lift- 42' | \$350.00 | Per Day |
| Telephone Line | \$125.00 | Per Line |
| High Speed Internet Line | \$175.00 | Per Line |
| Lectern (Standing, Table Top, ADA) | \$10.00 | Per Day |
| Microphone (Hand Held w/ Cord) | \$15.00 | Per Day |
| Microphone (Wireless Hand Held-VHF) | \$50.00 | Per Day |
| Microphone (Wireless Lavalier-VHF) | \$50.00 | Per Day |
| Risers- 16" or 24" (4'x8' Section) | \$0.55 | Per Sq. Foot |
| Risers- 36" (4'x8' Section) | \$0.75 | Per Sq. Foot |
| Orchestra Shell | \$150.00 | Per Event |
| Dance Floor (3'x3' Sections) | \$0.25 | Per Sq. Foot |
| Easel | \$7.00 | Per Day |
| Dry Erase Board | \$10.00 | Per Day |
| Flip Chart (Standard Paper) | \$15.00 | Per Day |
| Flip Chart (Sticky Paper) | \$25.00 | Per Day |
| Towels | \$4.00 | Each |
| Gaffe Tape | \$15.00 | Per Roll |
| Miscellaneous | | |
| House Sound Hook Up Fee | \$200.00 | One Time |
| Balloon Retrieval | \$250.00 | Per Balloon |
| Runner | \$225.00 | Per Day |

Note:

All equipment is available on a first come first serve basis. If additional rental items are needed they will be billed at vendor rental rates.